

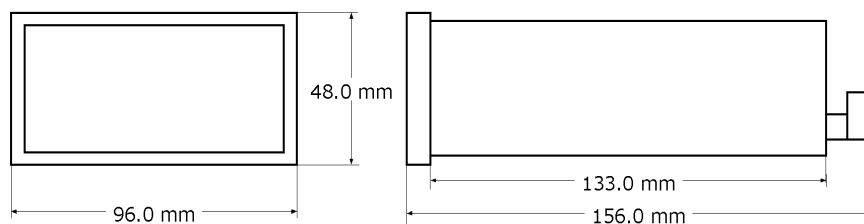

- DC-voltage-output for peltier-modules with low operating voltage
- only one voltage supply necessary
- pt1000-Sensors, 2-wire connection
- PID-Controller, programmable
- Signal-Input, function selectable: on, off, set-value selection, start of sinus-function
- Signal-output, alarm or temperature-OK function selectable
- Made in Switzerland

The Temperature Controller TC0806-RS232 is specially optimized for the driving of Peltier-modules. Most of the functions are programmable via the front switches or a PC program via its serial interface RS232.

Supply voltage	12.0 to 13.8V DC
Power output	DC-voltage-output, voltage configurable in steps of 0.1V between +/- 1.0 and +/- 8.0V control output for low-voltage Peltier-modules, output current up to 6A, automatically switching to cooling or heating mode
Controller	modified PID-Controller, parameter programmable
Sensor inputs	2-wire connection for pt1000 sensors
Sensor 1	temperature control
Sensor 2, 3	limiter function, output is muted, if temperature goes beyond threshold may be inhibited via setup, limit value programmable, suitable to limit the maximum temperature on cold / hot side of peltier-module
Reading and control range	-50.0 to +150.0 degrees Celsius nominal (monitoring -75.0 bis 175.0)
Reading resolution	0.1 degrees
Display	bright and large 7-Segment-LED Indication one LED to display cooling or heating mode, visualisation of setup mode
Control input	12 to 28V, isolated with Optocoupler
Signal output	max. 28V, NPN, isolated with Optocoupler, load current 100 mA max.
RS232 interface	PC-Software included , cable CA0806_1 available as option
Parameter	all parameters are permanently stored in flash memory
Dimensions	



Panel cutout: 92.5 mm x 43 mm

May be subject to technical changes without notice, 24.10.2016